

## 3734

Design By Antoni Arola

Nature takes control of space. With the pendant lamps, the interior ambiance takes on a life of its own with the possibility of integrating plants with the lighting compositions.

### Spec sheet

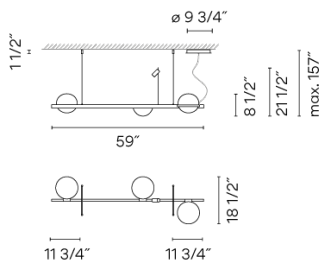

**Optional: Extra cable length**  
Min. Quantity, upcharge and extra lead time apply

<b>Finish</b>	<ul style="list-style-type: none"> <li><span style="display: inline-block; width: 10px; height: 10px; background-color: white; border-radius: 50%; margin-right: 5px;"></span> 93 White RAL 9016</li> <li><span style="display: inline-block; width: 10px; height: 10px; background-color: black; border-radius: 50%; margin-right: 5px;"></span> 18 Graphite ADAPTA RF 9913 WX</li> </ul>
<b>LED color temperature</b>	2700 K
<b>Dimming</b>	0-10V <b>Optional</b> DALI or Lutron ECO Min. Quantity, upcharge and extra lead time apply
<b>Installation type</b>	Surface mounted

**Materials**  
Profile: Aluminum  
Diffuser: Blown-glass  
Flowerpot: PMMA (thermoplastic polymer)  
Canopy: Steel

**Light source**  
4 x LED 4.6W 500mA  
1 x LED 2W 500mA  
A+

**LED**  
CRI>90 1828 lm 94.34  
2700 K

**Driver**  
CC - Constant Current 500  
120-277 V 50/60 HZ

**Remarks**  
Plants not included

Dimmable LED IP20 Multi-volt

UL Dry Location 50-60Hz 0-10V

**Application**  
Pendants

**Packaging**  
1 Box  
68.9 m x 12.99 m x 12.2 m  
Gross weight 20.84  
Net weight 13.11  
Vol. 6.3214

#### Lighting effect

##### General Lighting

Lamp for general lighting that equally distributes the light in all directions.

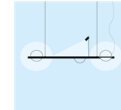

#### Photometric Data

<b>Efficiency</b>	1
<b>Coordination System</b>	CG
<b>Total Flux</b>	1301.84 lm
<b>Maximum Value</b>	66.04 cd/klm