

DUO by Rafa García, 2004 / 2022

DUO MAXI

DUO MINI

EXPLICACION DEL MODELO

DUO. Dos familias en una: MINI & MAXI

Estético y muy funcional, este básico en nuestro catálogo es un diseño de **Rafa García**. El diseñador reinterpreta con audacia esta creación para actualizarlo con dos versiones más contemporáneas. **Duo Mini & Duo Maxi** son la nueva propuesta definida para satisfacer las necesidades de diferentes espacios, bien domésticos o colectivos.

Su carácter modular le confiere una identidad flexible y versátil, especialmente gracias a las nuevas medidas. La diferencia entre **Mini & Maxi** es el fondo de su asiento y la modulación disponible. Además, para que cada uno de los módulos pueda usarse de forma independiente, hemos perfilado sus acabados a todos los niveles, porque cada pequeño detalle cuenta.

En la versión **Mini**, las reducidas dimensiones y la sencillez de la modularidad disponible facilitan el amueblamiento de espacios recogidos y compactos, propios de las grandes ciudades. Estos pueden funcionar sueltos a modo de silloncito.

Por otra parte, la versión **Maxi** propone ampliar el ancho de algunos módulos para obtener sofás de una sola pieza con generosas dimensiones. Su modulación es extensa e incluye módulos con brazo o sin brazo, módulos terminales, angulares y un puff que, articulados de forma variada, hacen posibles configuraciones casi infinitas, ideales para espacios públicos. También cabe destacar como novedad la posibilidad de realizar composiciones curvadas.

La amplia sentada de **Duo Maxi** permite jugar con cojines de decoración e, incluso, incorporar almohadones de respaldo extra.

Sus patas quedan ocultas, haciendo que su voluminosa silueta parezca flotar con ligereza sobre el suelo.

DESCRIPTION

DUO. Two families in one: MINI & MAXI

Both aesthetic and highly functional, the Duo by **Rafa García** has been a staple in our catalogue since 2004. Eighteen years later, the designer has boldly reinterpreted his creation, replacing it with **Duo Mini and Duo Maxi**.

Their sectional character gives them a flexible and versatile identity, accentuated by new sizes. The main differences between **Mini and Maxi** are the depth of the seat and the modules available. In addition, each of the modules can now be used independently and we have improved the finishes as every little detail counts.

The **Mini** version's reduced footprint, and the simplicity of its modules make it an ideal choice to furnish the compact spaces characteristic of large cities. Each module can even be used as a small, independent armchair.

On the other hand, the **Maxi** version extends the width of some modules to create single-piece sofas with generous dimensions. Its wide selection of modules includes elements with or without arms, end and corner modules and a pouf. They can be combined in a variety of ways to create almost infinite configurations, ideal for open public spaces. Another new feature is the possibility of creating curved compositions.

Duo Maxi's deep seat enables the playful use of scatter cushions or even extra back cushions.

Its hidden feet make its voluminous silhouette appear to float gracefully above the floor.

CARACTERISTIQUES

DUO. Deux familles en une seule : MINI & MAXI

Esthétique et fonctionnelle, ce basique de notre catalogue est un design de **Rafa García**. Le designer re-interprète avec audace cette création afin de l'actualiser avec 2 versions plus contemporaines. **Duo Mini & Duo Maxi** sont la nouvelle proposition définie pour satisfaire les nécessités de différents espaces, aussi bien domestiques que collectifs.

Son caractère modulable lui donne une identité flexible et polyvalente, surtout grâce aux nouvelles dimensions. La différence entre **Mini & Maxi** est la profondeur d'assise et la modularité disponible. De plus, afin que chacun des modules puisse être utilisé de manière indépendante, nous avons profilé leurs finitions à tous les niveaux, car chaque petit détail compte.

Dans la version **Mini**, les dimensions réduites et la simplicité de la modularité disponible facilitent l'aménagement d'espaces réduits et compacts, propres aux grandes villes. Ces modules peuvent fonctionner également seuls comme de petits fauteuils.

D'autre part, la version **Maxi** propose d'augmenter la largeur de certains modules pour obtenir des canapés d'une seule pièce aux dimensions généreuses. Sa modularité est étendue et inclut des modules avec ou sans bras, des modules terminaux, angles, et un pouf, qui, articulés de différentes manières, font des configurations quasi infinies, idéales pour les espaces publics. Aussi, il est important de souligner comme nouveauté, la possibilité de réaliser des compositions courbes.

La grande assise de **Duo Maxi** permet de jouer avec de nombreux coussins de décoration, et même, d'incorporer des coussins de dos extra.

Les pieds ne se voient pas, ce qui fait que cette volumineuse silhouette paraît flotter avec légèreté sur le sol.

ACABADOS / FINISHES / FINITIONS

PATAS / FEET / PIED

HAYA / BEECH / HÊTRE



030 WENGUE PLUS

FIRMEZA / FIRMNESS / FERMETÉ

SUAVE
SOFT
DOUX

--	--	--	--	--	--	--	--

FIRME
FIRM
FERME

IMPORTANTE

No es tapizable en piel. Los módulos tapizados en tela son totalmente desenfundables, aunque es necesario desmontar el asiento del respaldo. Incluye instrucciones.

Almohadas de respaldo opcionales no incluidas en el precio.

La unión de los módulos se realiza mediante carracas.

Las solicitudes de composiciones modulares deben adjuntar un plano en planta al realizar el pedido. La mano (derecha/izquierda) se interpreta siempre viendo el dibujo de frente.

Consulte www.sancal.com/care para obtener información sobre cuidado y mantenimiento.

CARACTERISTICAS TECNICAS**TELA**

- Módulos totalmente desenfundables.
- Estructura asiento: estructura de madera preparada con cinchas elásticas de 80mm en el asiento, recubierto con espuma de densidad diferenciada (CMHR 30kg/35kg /60), revestido con fibra de H100gr con velour.
- Estructura respaldo y brazo: estructura de madera, recubierto con espuma de densidad diferenciada (CMHR 30kg/35kg y CM25kg), revestido con fibra de H100gr con velour.
- Patas en madera de haya, acabadas en wengué plus (las patas quedan ocultas).
- Almohadas decoración respaldo y riñonera: funda de algodón rellena de FiberDream (microfibra tacto plumón).

PIEL

- No se fabrica.

IMPORTANT

This model is not available in leather. Totally removable fabric covers, although it is necessary to remove the seat from the backrest. Includes instructions.

Optional back cushions not included in the price.

The modules are joined by a ratchet system.

Requests for modular combinations must have a plan attached when placing the order. Left to right as facing the composition.

Consult www.sancal.com/care for essential care and maintenance information.

TECHNICAL SPECIFICATIONS**FABRIC**

- Totally removable covers.
- Seat structure: wood fitted with 80mm elastic webbing, covered with foam of varying densities (CMHR 30kg/35kg/60kg), covered in H100g fibre.
- Back and arm structure: wood, covered with foam of varying densities (CMHR 30kg/35kg and CM25kg), covered in H100g fibre.
- Solid beech feet stained in wenge plus (hidden feet).
- Scatter and lumbar cushions: cotton cover with FiberDream interiors (a down-like microfibre).

LEATHER

- This product is not available in leather.

IMPORTANT

Pas réalisable en cuir. Les modules tapissés en tissu sont entièrement déhoussables, bien qu'il soit nécessaire de démonter l'assise du dossier. Notice jointe.

Coussins de dossier optionnels ou de décoration non compris dans le prix.

L'union des modules se fait par pieces d'union.

Les commandes de compositions modulables doivent être obligatoirement accompagnées d'un plan. Le placement des bras gauches ou droits s'entend toujours vu de face par rapport au dessin.

Visitez www.sancal.com/care pour plus d'informations sur la sécurité et l'entretien.

CARACTERISTIQUES TECHNIQUES**TISSU**

- Modules 100% déhoussables.
- Châssis d'assise: structure en bois préparée avec des sangles élastiques de 80mm pour l'assise, recouvert en mousse de différentes densités (CMHR 30kg/35kg /60), avec fibre H100gr et recouvert d'une housse non tissée.
- Châssis de dos et bras : structure en bois, recouverte de mousse de différentes densités (CMHR 30kg/35kg y CM25kg), avec fibre H100gr et recouvert d'une housse non tissée.
- Pieds bois hêtre teinté wenge plus (non visibles).
- Coussins de décoration de dossier et cale-reins: housse coton garnie de fibre FiberDream (microfibre toucher plume).

CUIR

- Non disponible.

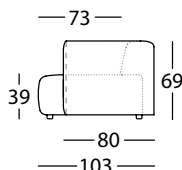
DUO MAXI

-15 CM.
FONDO / DEPTH / PROFONDEUR

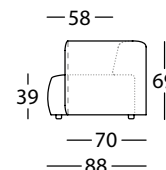
**DUO MINI**

Los asientos de los módulos del Duo Maxi tienen 15 cm. más de fondo que los asientos de los módulos del Duo Mini.
The seats of the modules of Duo Maxi are 15 cm. deeper than the seats of the Duo Mini modules.
Les assises des modules Duo Maxi mesurent 15 cm. plus profond que les sièges des modules Duo Mini.

DESCARGAS

Más información, ficheros 3D, 2D, BIM, certificados de resistencia, calidad y medio ambientales disponibles en:

www.sancal.com/es/sofa-duo

DOWNLOADS

More information, 3D, 2D, BIM files as well as certificates for resistance, quality and the environment can be downloaded from:

www.sancal.com/en/sofa-duo

TÉLÉCHARGEMENTS

Plus d'informations, fichiers 3D, 2D, BIM, certificats de résistance, de qualité et environnementaux disponibles sur :

www.sancal.com/en/sofa-duo

DUO MAXI

Ejemplos de composición / Composition examples / Exemples de compositions

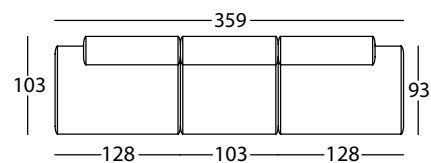
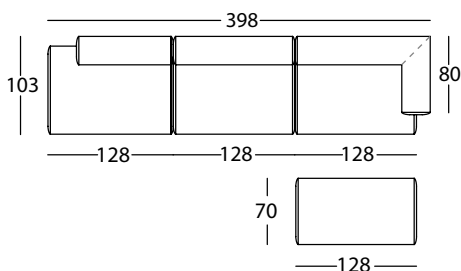
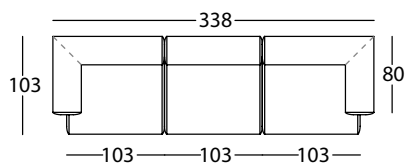

Ref: 364.122.M.I 364.121.L 364.122.M.D

364.17.N.I 364.121.N 364.122.Q.D

364.17.N.I 364.121.L 364.17.N.D

364.151.NH

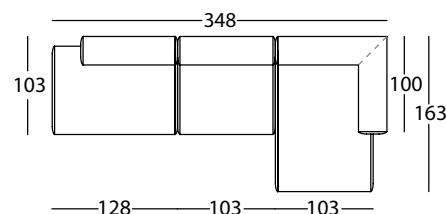
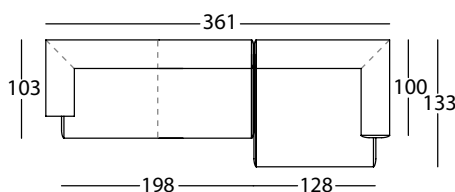
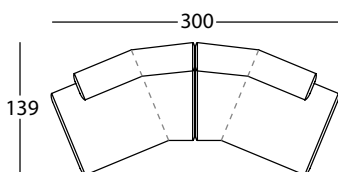

Ref: 364.17.S.AN.I 364.17.S.AN.D

364.122.X.I 364.142.Q.P.D

364.17.N.I 364.121.L 364.142.M.S.D

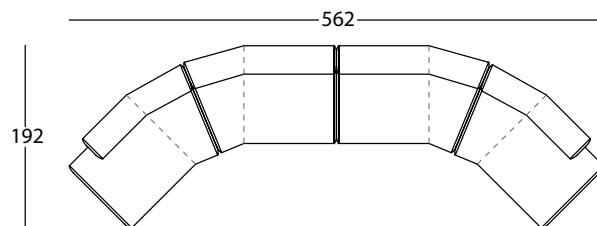
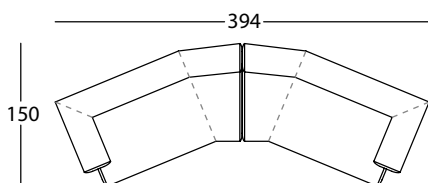

Ref: 364.16.W.I 364.16.W.D

364.17.S.AN.I 364.16.S.I 364.16.S.D 364.17.S.AN.D

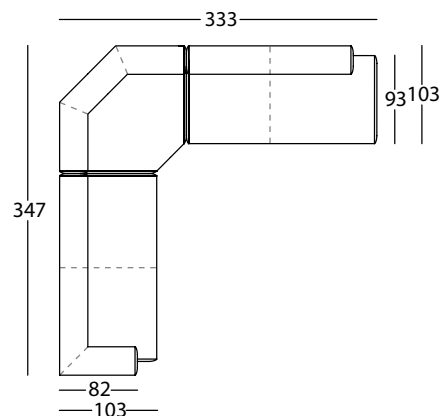
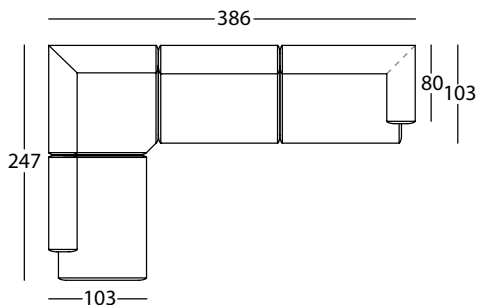

Ref: 364.161.M 364.121.N 364.122.M.D

364.161.P 364.17.M.D

364.17.N.I

364.122.X.I

DUO by Rafa García, 2004 / 2022



DUO MAXI

Modulos con brazo / Modules with arm / Modules avec bras

Modulos ángulo / Corner modules / Module angle

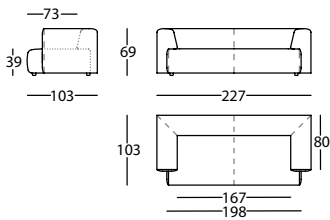

364.11.Z
 DUO MAXI SOFA 227
 DUO MAXI SOFA 227
 DUO MAXI CANAPE 227
 1,78 m³ / 1 Pack. / 88,4 kg

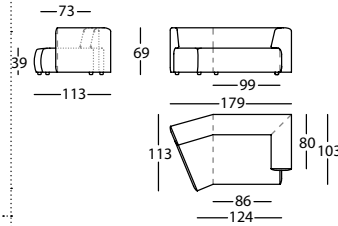

364.16.T.D
 DUO MAXI MODULO 179 BR DCHO ANGULO 22.5°
 DUO MAXI MODULE 179 RIGHT ARM CORNER 22.5°
 DUO MAXI MODULE 179 BRAS DROIT ANGLE 22.5°
 1,47 m³ / 1 Pack. / 64,0 kg

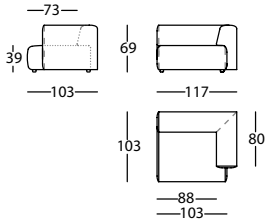

364.122.M.D
 DUO MAXI MODULO 117 BR DCHO
 DUO MAXI MODULE 117 RIGHT ARM
 DUO MAXI MODULE 117 BRAS DROIT
 0,91 m³ / 1 Pack. / 44,0 kg

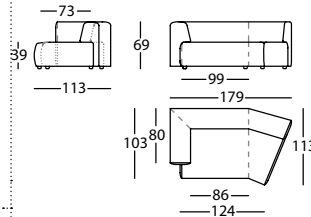

364.16.T.I
 DUO MAXI MODULO 179 BR IZDO ANGULO 22.5°
 DUO MAXI MODULE 179 LEFT ARM CORNER 22.5°
 DUO MAXI MODULE 179 BRAS GAUCHE ANGLE 22.5°
 1,47 m³ / 1 Pack. / 64,0 kg

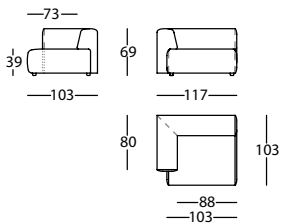

364.122.M.I
 DUO MAXI MODULO 117 BR IZDO
 DUO MAXI MODULE 117 LEFT ARM
 DUO MAXI MODULE 117 BRAS GAUCHE
 0,91 m³ / 1 Pack. / 44,0 kg

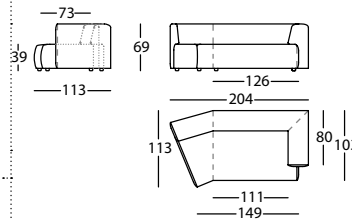

364.16.W.D
 DUO MAXI MODULO 204 BR DCHO ANGULO 22.5°
 DUO MAXI MODULE 204 RIGHT ARM CORNER 22.5°
 DUO MAXI MODULE 204 BRAS DROIT ANGLE 22.5°
 1,68 m³ / 1 Pack. / 68,0 kg

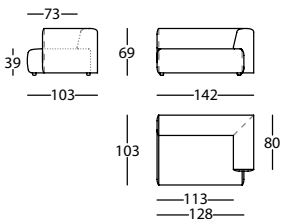

364.122.Q.D
 DUO MAXI MODULO 142 BR DCHO
 DUO MAXI MODULE 142 RIGHT ARM
 DUO MAXI MODULE 142 BRAS DROIT
 1,10 m³ / 1 Pack. / 54,7 kg

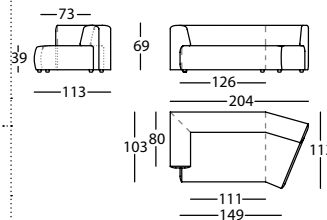

364.16.W.I
 DUO MAXI MODULO 204 BR IZDO ANGULO 22.5°
 DUO MAXI MODULE 204 LEFT ARM CORNER 22.5°
 DUO MAXI MODULE 204 BRAS GAUCHE ANGLE 22.5°
 1,68 m³ / 1 Pack. / 68,0 kg

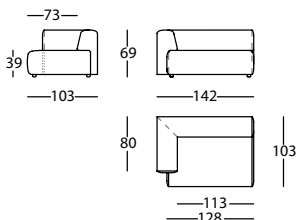

364.122.Q.I
 DUO MAXI MODULO 142 BR IZDO
 DUO MAXI MODULE 142 LEFT ARM
 DUO MAXI MODULE 142 BRAS GAUCHE
 1,10 m³ / 1 Pack. / 54,7 kg

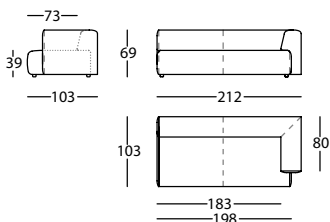

364.122.X.D
 DUO MAXI MODULO 212 BR DCHO
 DUO MAXI MODULE 212 RIGHT ARM
 DUO MAXI MODULE 212 BRAS DROIT
 1,66 m³ / 1 Pack. / 75,9 kg

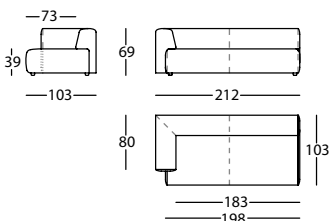

364.122.X.I
 DUO MAXI MODULO 212 BR IZDO
 DUO MAXI MODULE 212 LEFT ARM
 DUO MAXI MODULE 212 BRAS GAUCHE
 1,66 m³ / 1 Pack. / 72,0 kg

DUO by Rafa García, 2004 / 2022

DUO MAXI

Modulos / Modules

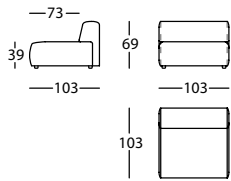
**364.121.L**

DUO MAXI MODULO 103
DUO MAXI MODULE 103
DUO MAXI MODULE 103

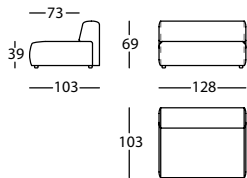
0,78 m³ / 1 Pack. / 36,0 kg**364.121.N**

DUO MAXI MODULO 128
DUO MAXI MODULE 128
DUO MAXI MODULE 128

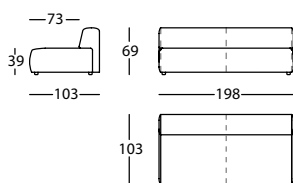
0,97 m³ / 1 Pack. / 45,2 kg**364.121.V**

DUO MAXI MODULO 198
DUO MAXI MODULE 198
DUO MAXI MODULE 198

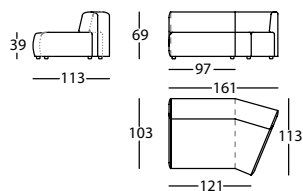
1,50 m³ / 1 Pack. / 67,3 kg**364.16.S.D**

DUO MAXI MODULO 161 ANGULO 22.5° DCHO
DUO MAXI MODULE 161 CORNER 22.5° RIGHT
DUO MAXI MODULE 161 ANGLE 22.5° DROIT

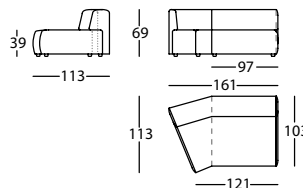
1,34 m³ / 1 Pack. / 53,0 kg**364.16.S.I**

DUO MAXI MODULO 161 ANGULO 22.5° IZDO
DUO MAXI MODULE 161 CORNER 22.5° LEFT
DUO MAXI MODULE 161 ANGLE 22.5° GAUCHE

1,34 m³ / 1 Pack. / 53,0 kg

Chaise / Chaise longue

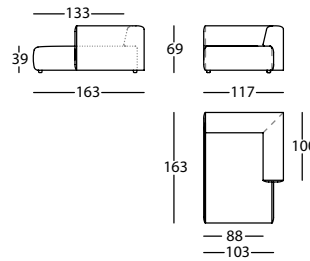
**364.142.MS.D**

DUO MAXI CHAISE 117X163 BR DCHO
DUO MAXI CHAISE 117X163 RIGHT ARM
DUO MAXI CHAISE 117X163 BRAS DROIT

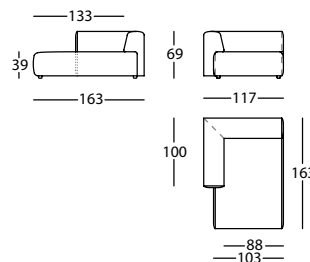
1,43 m³ / 1 Pack. / 61,0 kg**364.142.MS.I**

DUO MAXI CHAISE 117X163 BR IZDO
DUO MAXI CHAISE 117X163 LEFT ARM
DUO MAXI CHAISE 117X163 BRAS GAUCHE

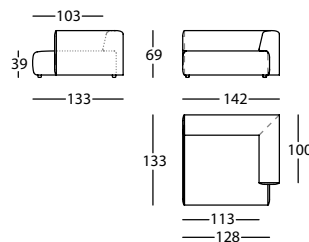
1,43 m³ / 1 Pack. / 61,0 kg**364.142.QPD**

DUO MAXI CHAISE 142X133 BR DCHO
DUO MAXI CHAISE 142X133 RIGHT ARM
DUO MAXI CHAISE 142X133 BRAS DROIT

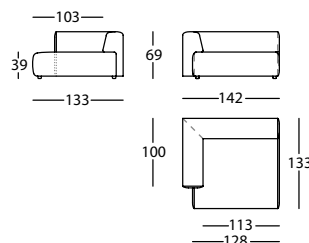
1,41 m³ / 1 Pack. / 60,0 kg**364.142.QPI**

DUO MAXI CHAISE 142X133 BR IZDO
DUO MAXI CHAISE 142X133 LEFT ARM
DUO MAXI CHAISE 142X133 BRAS GAUCHE

1,41 m³ / 1 Pack. / 60,0 kg

DUO by Rafa García, 2004 / 2022



DUO MAXI

Terminales / Terminals

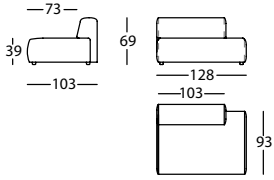

364.17.N.D

DUO MAXI TERMINAL 128 DCHO
DUO MAXI RIGHT TERMINAL 128
DUO MAXI TERMINAL 128 DROIT

0,97 m³ / 1 Pack. / 41,0 kg

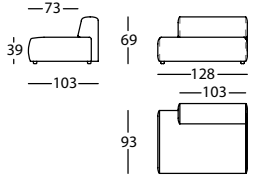

364.17.N.I

DUO MAXI TERMINAL 128 IZDO
DUO MAXI LEFT TERMINAL 128
DUO MAXI TERMINAL 128 GAUCHE

0,97 m³ / 1 Pack. / 45,2 kg

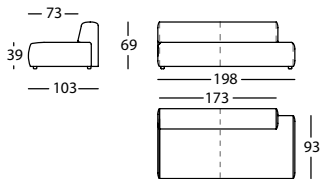

364.17.V.D

DUO MAXI TERMINAL 198 DCHO
DUO MAXI RIGHT TERMINAL 198
DUO MAXI TERMINAL 198 DROIT

1,50 m³ / 1 Pack. / 64,0 kg

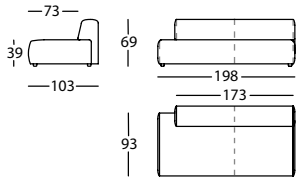

364.17.V.I

DUO MAXI TERMINAL 198 IZDO
DUO MAXI LEFT TERMINAL 198
DUO MAXI TERMINAL 198 GAUCHE

1,50 m³ / 1 Pack. / 73,3 kg

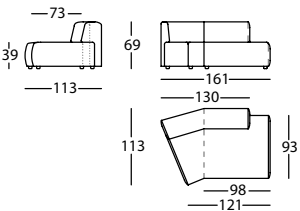

364.17.S.A.N.D

DUO MAXI TERMINAL 161 DCHO ANGULO 22.5°
DUO MAXI RIGHT TERMINAL 161 CORNER 22.5°
DUO MAXI TERMINAL DROIT 161 ANGLE 22.5°

1,34 m³ / 1 Pack. / 51,0 kg

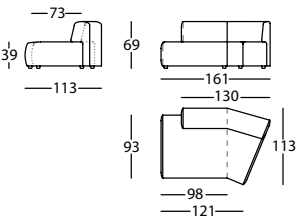

364.17.S.A.N.I

DUO MAXI TERMINAL 161 IZDO ANGULO 22.5°
DUO MAXI LEFT TERMINAL 161 CORNER 22.5°
DUO MAXI TERMINAL GAUCHE 161 ANGLE 22.5°

1,34 m³ / 1 Pack. / 51,0 kg

Angulo y puf / Corner & pouf / Angle et pouf

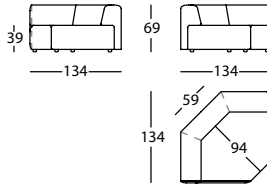

364.161.P

DUO MAXI ANGULO 90° 134X134
DUO MAXI 90° CORNER 134X134
DUO MAXI ANGLE 90° 134X134

1,33 m³ / 1 Pack. / 60,7 kg

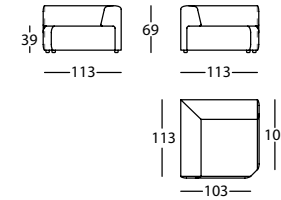

364.161.M

DUO MAXI ANGULO 90° 113X113
DUO MAXI 90° CORNER 113X113
DUO MAXI ANGLE 90° 113X113

0,98 m³ / 1 Pack. / 51,0 kg

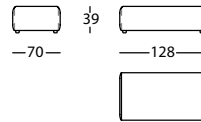

364.151.NH

DUO MAXI PUF 128X70
DUO MAXI POUF 128X70
DUO MAXI POUF 128X70

0,39 m³ / 1 Pack. / 20,0 kg



Almohadas / Cushions / Coussins

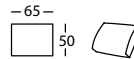

364.21.HF

DUO MAXI ALMOHADA DECORACION 65X50
DUO MAXI SCATTER CUSHION 65X50
DUO MAXI COUSSIN 65X50

- m³ / 1 Pack. / 2,2 kg

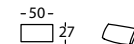

364.27.FC

DUO MAXI ALMOHADA RIÑONERA 50X27
DUO MAXI LUMBAR CUSHION 50X27
DUO MAXI COUSSIN CALE REIN 50X27

- m³ / 1 Pack. / 0,8 kg

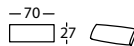

364.27.HC

DUO MAXI ALMOHADA RIÑONERA 70X27
DUO MAXI LUMBAR CUSHION 70X27
DUO MAXI COUSSIN CALE REIN 70X27

- m³ / 1 Pack. / 1,2 kg

DUO MINI

Ejemplos de composición / Composition examples / Exemples de compositions

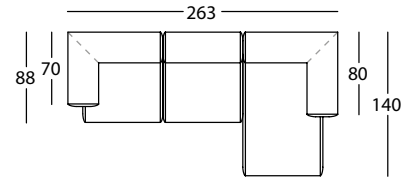
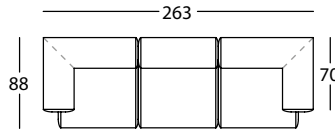
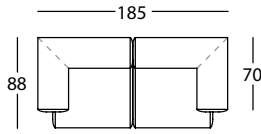

Ref: 365.122.K.I 365.122.K.D

365.122.K.I 365.121.H 365.122.K.D

365.122.K.I 365.121.H 365.142.K.D

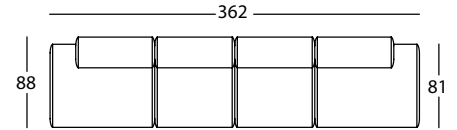
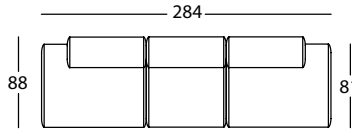
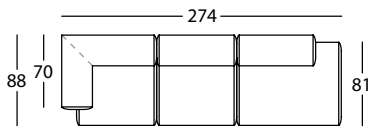

Ref: 365.122.K.I 365.121.H 365.17L.D

365.17L.I 365.121.H 365.17L.D

365.17L.I 365.121.H 365.121.H 365.17L.D

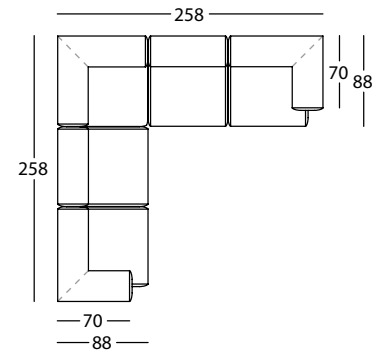
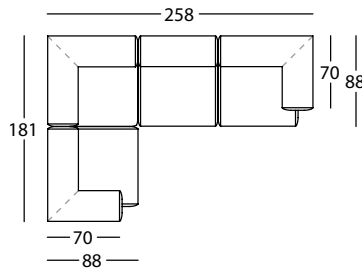
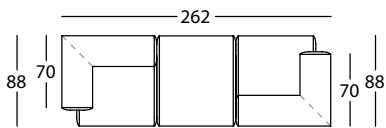

Ref: 365.122.K.I 365.151.H 365.122.K.I

365.161.J 365.121.H 365.122.K.D

365.161.J 365.121.H 365.122.K.D

365.122.K.I

365.121.H

365.122.K.I

DUO by Rafa García, 2004 / 2022

DUO MINI

Modulos y Chaise / Modules and Chaise longue /
Modules et Chaise longue

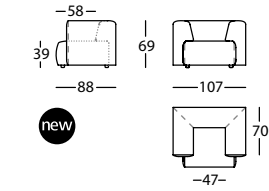
**365.61.LJ**

DUO MINI SILLON 107
DUO MINI ARMCHAIR 107
DUO MINI FAUTEUIL 107

0,83 m³ / 1 Pack. / 43,0 kg

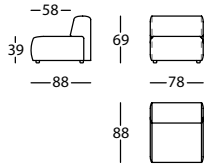
**365.121.H**

DUO MINI MODULO 78
DUO MINI MODULE 78
DUO MINI MODULE 78

0,51 m³ / 1 Pack. / 27,4 kg

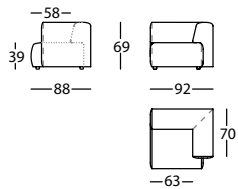
**365.122.K.D**

DUO MINI MODULO 92 BR DCHO
DUO MINI MODULE 92 RIGHT ARM
DUO MINI MODULE 92 BRAS DROIT

0,62 m³ / 1 Pack. / 35,2 kg

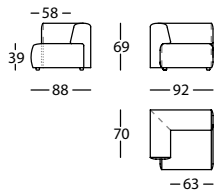
**365.122.K.I**

DUO MINI MODULO 92 BR IZDO
DUO MINI MODULE 92 LEFT ARM
DUO MINI MODULE 92 BRAS GAUCHE

0,62 m³ / 1 Pack. / 35,2 kg

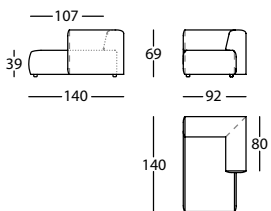
**365.142.K.D**

DUO MINI CHAISE 92X140 BR DCHO
DUO MINI CHAISE 92X140 RIGHT ARM
DUO MINI CHAISE 92X140 BRAS DROIT

0,98 m³ / 1 Pack. / 44,9 kg

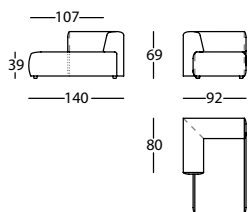
**365.142.K.I**

DUO MINI CHAISE 92X140 BR IZDO
DUO MINI CHAISE 92X140 LEFT ARM
DUO MINI CHAISE 92X140 BRAS GAUCHE

0,98 m³ / 1 Pack. / 44,9 kg

Terminal, ángulo y puf / Terminal, corner and pouf /
Terminal, angle et pouf

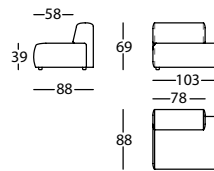
**365.17L.D**

DUO MINI TERMINAL 103 DCHO
DUO MINI RIGHT TERMINAL 103
DUO MINI TERMINAL 103 DROIT

0,67 m³ / 1 Pack. / 34,5 kg

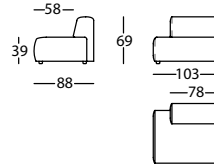
**365.17L.I**

DUO MINI TERMINAL 103 IZDO
DUO MINI LEFT TERMINAL 103
DUO MINI TERMINAL 103 GAUCHE

0,67 m³ / 1 Pack. / 34,5 kg

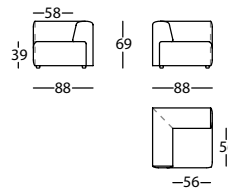
**365.161.J**

DUO MINI ANGULO 90° 88X88
DUO MINI 90° CORNER 88X88
DUO MINI ANGLE 90° 88X88

0,58 m³ / 1 Pack. / 39,1 kg

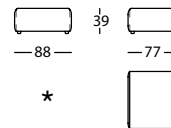
**365.151.H**

DUO MINI PUF 77X88
DUO MINI POUF 77X88
DUO MINI POUF 77X88

0,27 m³ / 1 Pack. / 19,4 kg

★ Válido para colocarlo entre módulos. No válido para hacer ángulo.
Can be attached between modules. Not valid as an angle module.
Valable pour le placer entre les modules. Non valide pour l'angle.