

## MILANO 1932

### SCINTILLA LARGE

Piero e Livio Castiglioni, 1972

The absolutely novel Scintilla system combines the essential versatility of a decorative lamp and a lighting capacity comparable to a technical system. The great success of this system persuaded the company to design a free-standing version in the early eighties, with the main structure fastened to the base and stem in metal.

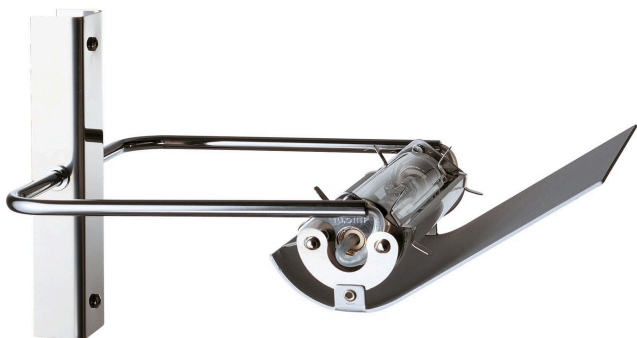

Wall lamp with diffused and dimmable light. Chromed metal frame. The lamp is supplied with two different diffusers: one in clear borosilicate glass and the other in sandblasted borosilicate glass. Available separately a reflector made of anodized aluminum reflector that produces indirect light. Bulb not included.

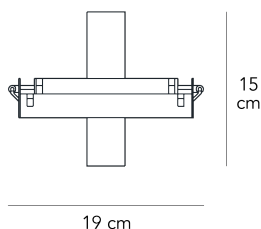

#### MADE IN

IT

#### DIMMER

Dimmable

#### CERTIFICATIONS

CE ENEC IP20 

#### COLOR



#### MATERIAL DESCRIPTION

metal, glass

#### COLOR DESCRIPTION SKU

chrome

#### GROUP TENSION

Bulb

#### ENERGY CLASS

A+ >> E

#### LIGHT SOURCE

HA 1x230W R7s/115 (2900K, 5000Lm)

**SKU**

FP30050250CRNE