

TECHNICAL SPECIFICATION

2001 Side tables

Ramón Úbeda & Otto Canalda
2017



COMPONENTS, MATERIALS & FINISHES:

Tops ultra-clear tempered glass with mirror finish.
Bases pyrex tubes with mirror finish.

DIMENSIONS & WEIGHT:

ϕ 45 x 45h cm - 7,5 Kg // ϕ 17.7" x h17.7" - 16.5lbs
 ϕ 65 x 35h cm - 16,5 Kg // ϕ 25.5" x h13.7" - 34.2lbs
 ϕ 65 x 25h cm - 16,5 Kg // ϕ 25.5" x h9.8" - 34.2lbs

PACKAGING:

The products are sent packed into a wooden box.

CLEANING & MAINTENANCE

Clean with glass cleaning products.
Do not clean the inside.

USAGE INDICATIONS (for any of the three models):

The maximum allowed load is 8 Kg / 17.6 lbs
Forbidden to sit or lean.

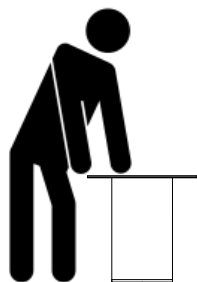
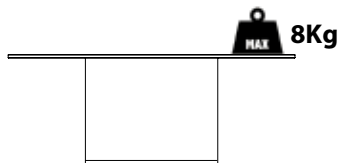
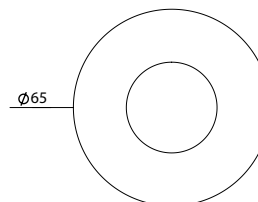
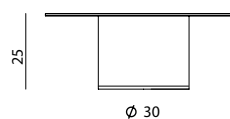
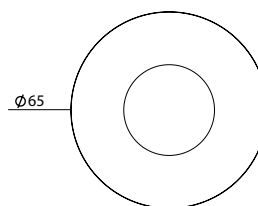
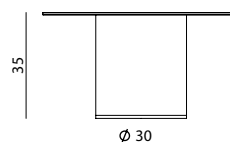
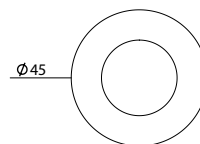
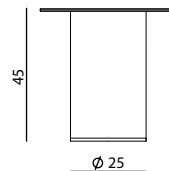

MEASUREMENTS IN CM and INCHES

ACTUALIZACIÓN: 05/10/2021
FT-20-CS



Bd Barcelona design

Ramon Turró, 126 / 08005 Barcelona
Tel +34 93 458 69 09 / Fax +34 93 207 36 97
bd@bdbarcelona.com / www.bdbarcelona.com

Technical department

Carretera Capellades / km 22,750
Narcís Monturiol, 7 / Pol. Ind Sesrovires
Sant Esteve de Sesrovires / 08635 Barcelona
Tel +34 93 771 30 51

FICHA TÉCNICA

2001 Side tables

Ramón Úbeda y Otto Canalda
2017



COMPONENTES, MATERIALES Y ACABADOS:

Sobre de vidrio ultraclaro templado con acabado espejo.
Base tubo de pyrex con acabado espejado.

DIMENSIONES Y PESOS:

Ø 45 x 45h cm - 7,5 Kg
Ø 65 x 35h cm - 16,5 Kg
Ø 65 x 25h cm - 16,5 Kg

EMBALAJE:

Los productos se envían dentro de una caja de madera.

LIMPIEZA Y MANTENIMIENTO

Limpiar con productos de limpieza especiales para vidrio.
No limpiar parte interior

INDICACIONES DE USO (para cualquiera de los tres modelos):

La carga máxima admitida encima del sobre es de 8Kg.
Prohibido sentarse o apoyarse.

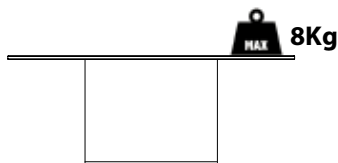
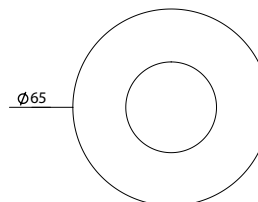
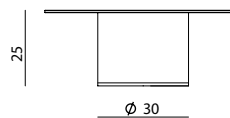
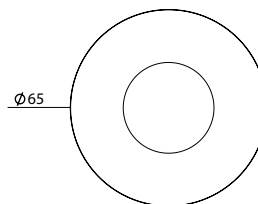
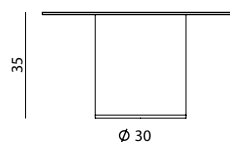
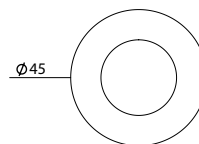
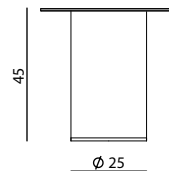

MEDIDAS EN CM y PULGADAS

ACTUALIZACIÓN: 05/10/2021
FT-20-CS



Bd Barcelona design

Ramón Turró, 126 / 08005 Barcelona
Tel +34 93 458 69 09 / Fax +34 93 207 36 97
bd@bdbarcelona.com / www.bdbarcelona.com

Oficina Técnica

Carretera Capellades / km 22,750
Narcís Monturiol, 7 / Pol. Ind Sesrovires
Sant Esteve de Sesrovires / 08635 Barcelona
Tel +34 93 771 30 51