

Flat

VIBIA

5905

Design By Ichiro Iwasaki

Flat is a ceiling lamp composed of horizontal discs at various heights that create planes of reflected light. The Flat ceiling light has a strong graphic quality, combining structure and functionality.

Model Sheet

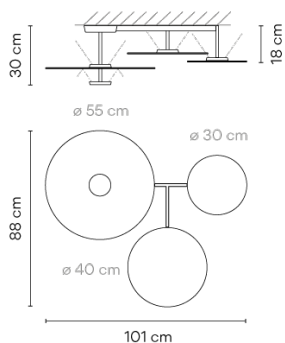

Finish

- 71 White, Green L1, Grey L1
NCS S 0300-N, NCS S 4005-G80Y, NCS S 1000-N
- 10 White
NCS S 0300-N

LED temperature color 2700 K / 3500 K / 4000 K

Dimming Push; 1-10V; DALI

Installation type Surface Canopy

Materials

- Ceiling rose: Steel
- Reflector: Aluminum
- Body: Steel
- Head: Aluminium

Light source 4 x LED PLATE 13,5W 700mA



LED CRI>90 6960 lm 128.88
2700 K / 3500 K / 4000 K

Driver Constant Current 700
220~240 V V 50~60 Hz HZ

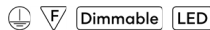

Application Ceiling Lamps

Packaging 1 Box
0.727 m x 0.727 m x 0.32 m
Gross weight 25.8
Net weight 15.38
Vol. 0.1691

Lighting effect

General Lighting

Lamp that emits an upward or backward beam that is reflected by the ceiling or wall.

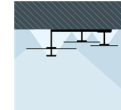

Photometric Data

Efficiency 68.21 lm/W
Coordinate System CG
Total Flux 3015.66 lm
Maximum Value 826.00 cd

Other Applications

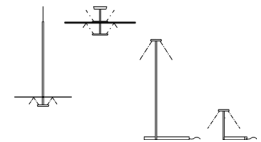

All of our products come with a five-year warranty. Check our legal terms at www.vibia.com/warranty

Vibia Lighting, S.L.U.

Office / Oficina
Progrés 4-6. 08850 Gavà. Barcelona, Spain.

International T +34 934 796 971
Spain / Portugal T +34 934 796 970

customer.service@vibia.com
vibia.com